

NON TRANSFERABLE

TEST REPORT

No.SHL/239/2008-09/2092/0673

Date: 09.08.2008

1.0 NAME AND ADDRESS OF THE CUSTOMER : Protectron Electromech (P) Ltd.,
D-11-14 Brigade MM,
7th Block, Jayanagar, K.R. Road,
Bangalore,
Karnataka 560 070

2.0 CUSTOMER LETTER REF. : Letter Ref. No. Nil
Dt 15 07 2008

3.0 DESCRIPTION OF COMPONENT :
Electrical fuse Part No. PTF 200 15A

As informed by the customer, Electrical fuses having 15 Amps ratings are manufactured by M/s Protectron Electromech (P) Ltd.

Drawing of electrical fuse having 15 amps rating bearing Drawing No.: PTF 200 15A Rev. No. A is attached herewith.

4.0 TEST OBJECTIVE :

To evaluate performance of electric fuse as per the test requirements given in AIS 026 Cl. No. 12 (c) & AIS 028 Cl. No. 4 3.3

5.0 TEST REQUIREMENTS / RESULTS:

Requirements of AIS 026 Cl. No. 12 (c) & AIS 028 Cl. No. 4 3.3 for electrical fuse are given in Table-1 on Page No. 2



Page 1 of 3

Test Report No. SHL/239/2008-09/2092/0673

Table-1

Sr. No.	Rated current of the fuse	Current supplied to the Fuse at 12 V /24 V DC	Requirement	Observations
1	15 Amps	135% of the rated current i.e. 20.25 A	Fuse element shall fuse within 60 seconds.	Fuse element fused within 60 sec when current of 20.3 A passed through the fuse. i) 1 st Sample Fused in 10 sec. ii) 2 nd Sample Fused in 12 sec. iii) 3 rd Sample Fused in 10 sec.
		110% of the rated current i.e. 16.5 A	Fuse element shall not fuse within 60 min.	No fusing observed when current of 16.5 A is passed through the fuse for 60 minutes.

6.0 CONCLUSION:

Electric fuse (5 A) bearing Part No. PTF 200 15A; manufactured and submitted by M/s Protectron Electromech (P) Ltd Bangalore, meet the test requirements when tested as per AIS 026 Cl. No. 12 (c) & AIS 028 Cl. No. 4.3.3.

PREPARED BY:

S. N. Londhe
S. N. LONDHE
TECH. ASSISTANT

CHECKED BY:

Ajay D. Dekate
AJAY D. DEKATE
PROJECT ENGINEER

APPROVED BY:

M. G. R. Pillai
M. G. R. PILLAI
ASSISTANT DIRECTOR, SHL

Place of Issue: PUNE

Date of Issue: *09/08/08*

DISCLAIMER:

This test report pertains only to the components / parts / assemblies / vehicles etc. actually tested at ARAI in the presented condition based on the documents / information produced / submitted by the customer. The issuance of this test report alone does not indicate any measure of approval, certification, supervision, control of quality surveillance by ARAI of the product. No extract, abridgement or abstraction from this test report shall be published or used to advertise the product without the written consent of the Director, ARAI, who reserves the absolute right to agree or reject all or any of the details of any items of publicity for which consent may be sought. ARAI is in no way responsible for any misuse of copying of any design / type / system in connection with entire vehicle / components / parts and assemblies. Breach of any statutory provision of Indian laws or laws of other countries, will be the sole responsibility of the customer and ARAI shall not be liable for any claims or damages, made by the Party, whatsoever, the customer shall alone be liable for the same, and undertakes to indemnify ARAI in this regard. Further, the ARAI has the right to initiate cancellation / withdrawal of the certificate issued, in case of any fraud, misrepresentation, when it surfaces and comes in the knowledge of ARAI. The appropriate local courts at Pune shall have the jurisdiction in respect of any dispute, claim or liability arising out of this report.

L:\S&HS & H deklattestreports\08-09\0673\CC\239-CING-LPG\2092-0673 (Fuse-Protectron)2.doc

DESC: BLADE FUSE - STANDARD PLUG IN TYPE

Part No PTF 200 15A

REV. A

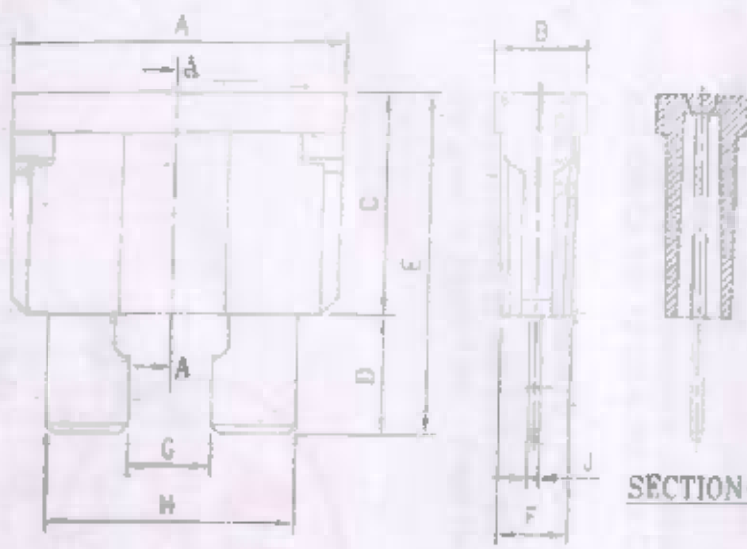

SECTION-AA

NOMINAL CURRENT RANGE (In)	BODY COLOUR	PART NUMBERS
15A	BLUE	PTF 200 15A



DRAWING REFERENCES	DIMENSIONS IN MM.	
	MM	INCH
A	18.87	0.743
B	4.99	0.196
C	-	12.54
D	4.17	0.164
E	18.41	0.725
F	3.99	0.157
G	3.99	0.157
H	14.25	0.561
J	0.61	0.024

DESIGN STANDARDS:

1. U.L. STANDARD FOR AUTOMOTIVE BLADE TYPE FUSES / SAEJ1284 / JASO 2619-97
 For PROTECTRON ELECTROMECH (P) LTD.

RATED VOLTAGE : DC 32V OR LESS

INTERRUPTING RATING 1000A @ 32VDC

MARKINGS ON THE FUSE SHOULD BE AS FOLLOWS:-

'AMPERAGE', 'VOLTAGE RATING' AND 'PROTECTRON' (MANUFACTURER)

Authorized Signatory
 PROTECTRON ELECTROMECH (P) LTD.
 Bangalore - 560 075 Ph: 26760396

Test Report NO. SHC/269/2008-09/2092/0673 Date: 09/09/2008

ZONE	DESCRIPTION	CHECKED BY	DATE	DOCUMENT CODE	ALL DIMENSIONS ARE IN MM UNLESS OTHERWISE SPECIFIED.
A	ORIGINAL	[Signature]	08 07 2008		
				MATERIAL & FINISH PLASTIC BODY - POLYCARBONATE ELEMENT - ZINC	PROTECTRON ELECTROMECH (P) LTD. Bangalore, INDIA
				HEAT TREATMENT	This Document is the property of PROTECTRON ELECTROMECH (P) LTD. It shall not be reproduced or circulated without the prior written consent of the Company.
				DRAWN BY CHATRA DATE 08 07 2008	APP'D BY [Signature]

page 3 of 3